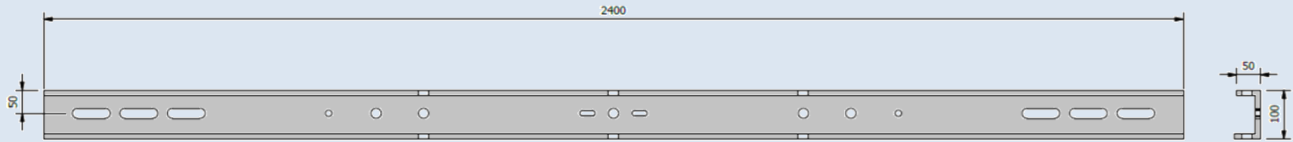
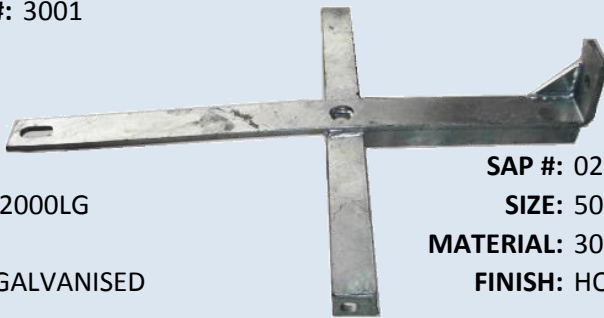
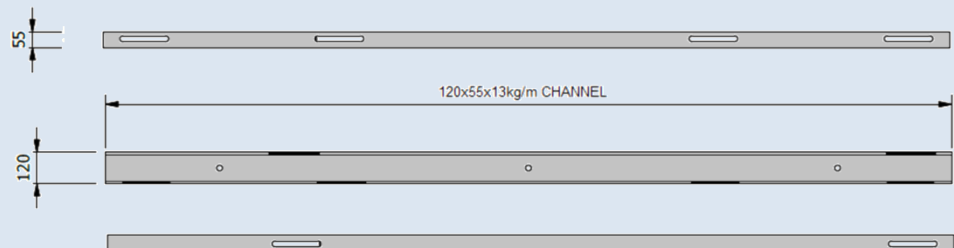
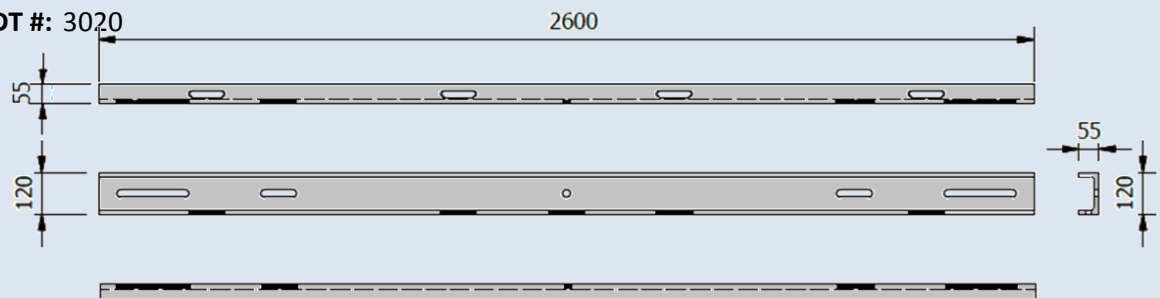

CROSSARMS

1-1

DESCRIPTION: STEEL CHANNEL CROSSARM**D-DT #:** 3000**NOTES:**

STEEL CHANNEL CROSSARM; H-POLE
MOUNTED FOR CUT OUT BRACKET

SAP #: 0189877**SIZE:** 100 x 50 x 10.73kg/m, 2.4m LONG**MATERIAL:** STEEL PARALLEL FLANGE CHANNEL S355JR**FINISH:** HOT DIP GALVANISED**DESCRIPTION:** INTERMEDIATE "T" CROSSARM ASSEMBLY**D-DT #:** 3001**SAP #:** 0168689**SIZE:** 90x65x8x2000LG**MATERIAL:** 300WA**FINISH:** HOT DIP GALVANISED**SAP #:** 0206691**SIZE:** 50x50x6x600LG**MATERIAL:** 300WA**FINISH:** HOT DIP GALVANISED**DESCRIPTION:** H-POLE MOUNTED VOLTAGE REGULATOR PLATFORM**D-DT #:** 3016**SAP #:** 0189726**SIZE:** 120x55x13x2600 LONG CHANNEL**MATERIAL:** S355JR / 350WA**FINISH:** HOT DIP GALVANISED**SAP #:** 0189727**SIZE:** 120x55x13x3000 LONG CHANNEL**MATERIAL:** S355JR / 350WA**FINISH:** HOT DIP GALVANISED**DESCRIPTION:** H-POLE MOUNTED EQUIPMENT PLATFORM**D-DT #:** 3020**SAP #:** 0175465**SIZE:** 120x55x13x2600 LONG CHANNEL**MATERIAL:** S355JR / 350WA**FINISH:** HOT DIP GALVANISED

CROSSARMS

1-2

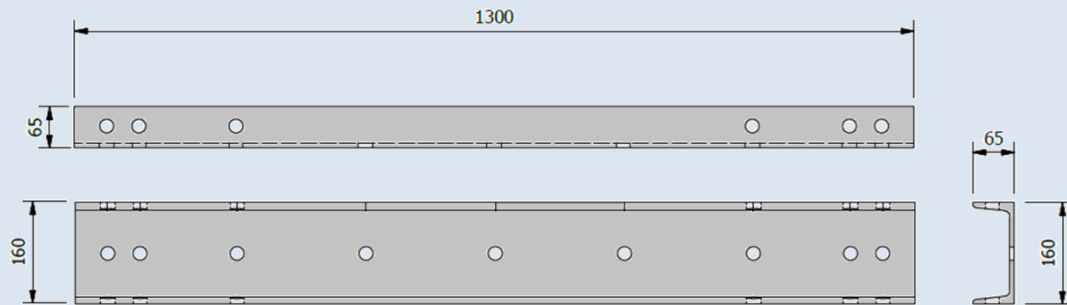
DESCRIPTION: STEEL CHANNEL, FOX/MINK**D-DT #:** 3027**NOTES:**

FOR USE ON A FOX/MINK CONDUCTOR

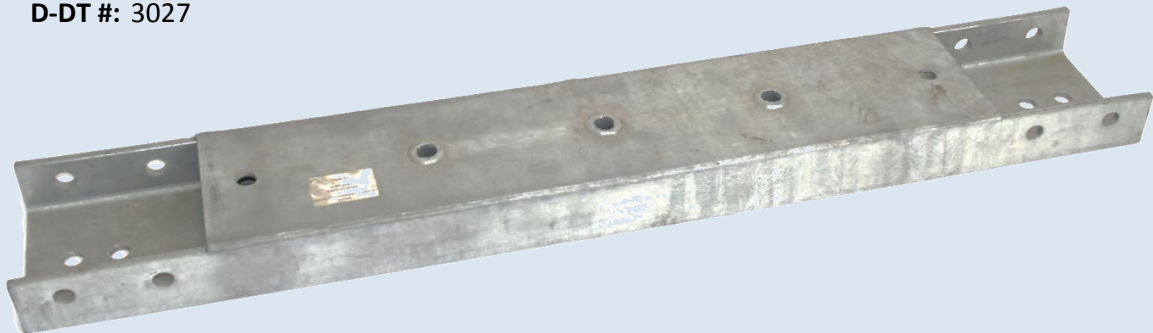
SAP #: 0168562**SIZE:** 160x65x19.1 kg/m, 1.3m LG**MATERIAL:** S355JR/350WA STEEL TAPER FLANGED CHANNEL**FINISH:** HOT DIP GALVANISED**DESCRIPTION:** STEEL CROSSARM WITH STEEL PLATE, HARE**D-DT #:** 3027**NOTES:**

FOR USE ON A HARE CONDUCTOR

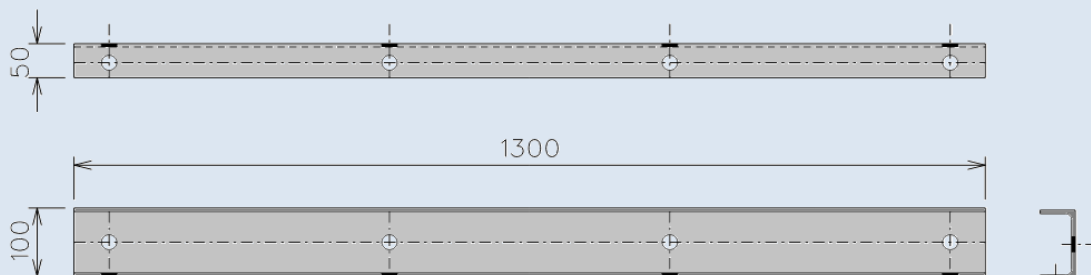
SAP #: 0168588**SIZE:** 200x75x25 kg/m, 1.3m LG**MATERIAL:** S355JR/350WA STEEL TAPER FLANGED CHANNEL**FINISH:** HOT DIP GALVANISED**DESCRIPTION:** STEEL CROSSARM, COMBI UNIT**D-DT #:** 3027**NOTES:**

UTILISED AS A MOUNTING CHANNEL FOR A COMBI UNIT

SAP #: 0251973**SIZE:** 100x50x10.1 kg/m, 1.3m LG**MATERIAL:** S355JR/350WA STEEL PARALLEL FLANGED CHANNEL**FINISH:** HOT DIP GALVANISED

CROSSARMS

1-3

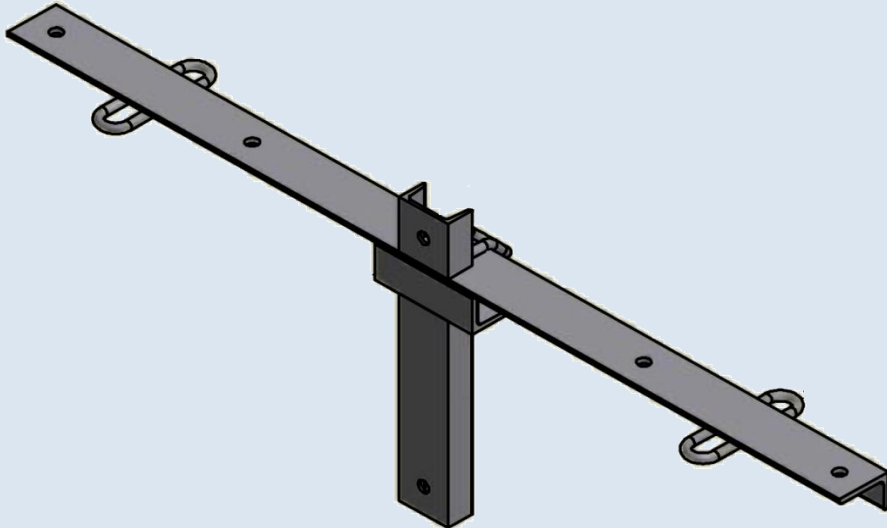
DESCRIPTION: MV STRAIN CROSSARM**DESCRIPTION:** MV STRAIN CROSSARM, FOX**D-DT #:** 3071**SAP #:** 0179726**SIZE:** 100 x 65 x 10 x 1700mm LONG**MATERIAL:** 300WA**FINISH:** HOT DIP GALVANISED**NOTES:**

USED FOR FOX CONDUCTOR

DESCRIPTION: MV STRAIN CROSSARM, MINK+HARE**D-DT #:** 3072**SAP #:** 0179727**SIZE:** 125 x 75 x 12 x 1700mm LONG**MATERIAL:** 300WA**FINISH:** HOT DIP GALVANISED**NOTES:**

STRENGTH SUITABLE FOR MINK AND HARE CONDUCTOR

DESCRIPTION: MV STRAIN CROSSARM, CHICADEE - KINGBIRD**D-DT #:** 3072**SAP #:** 0224546**SIZE:** 150 x 75 x 12 x 1700mm LONG**MATERIAL:** 300WA**FINISH:** HOT DIP GALVANISED**NOTES:**

STRENGTH SUITABLE FOR CHICADEE TO KINGBIRD CONDUCTOR

CROSSARMS

1-4

DESCRIPTION: MV A-FRAME SUSPENSION CROSSARM ASSEMBLY
D-DT #: 3154

SAP #: 0214878
SIZE: 1500 LONG
MATERIAL: S355JR/350WA STEEL
FINISH: HOT DIP GALVANISING

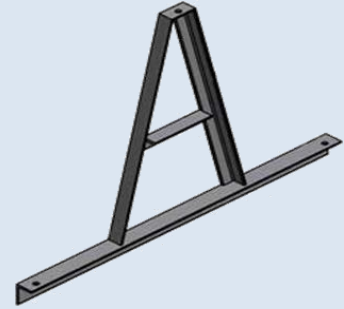

DESCRIPTION: MV A-FRAME STRAIN CROSSARM ASSEMBLY
D-DT #: 3155

SAP #: 0214879
SIZE: 1500 LONG
MATERIAL: S355JR/350WA STEEL
FINISH: HOT DIP GALVANISING

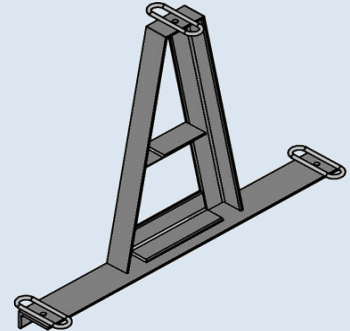

DESCRIPTION: ANGLE IRON CROSSARMS

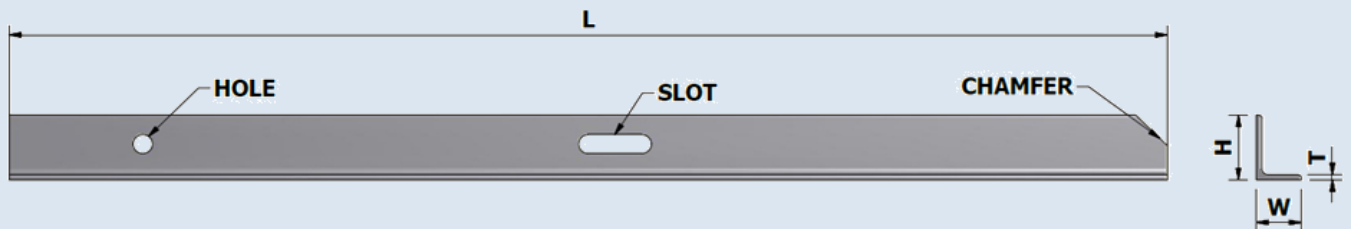

SIZE: VARIABLE - MANUFACTURED AS PER CUSTOMER REQUIREMENTS

DESCRIPTION: CHANNEL IRON CROSSARMS

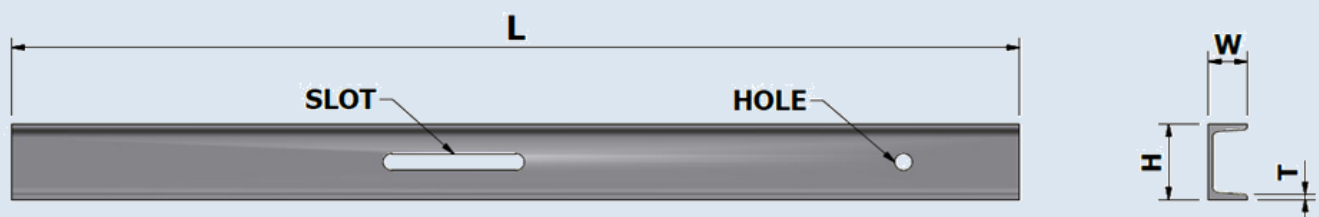

SIZE: VARIABLE - MANUFACTURED AS PER CUSTOMER REQUIREMENTS

STAY ASSEMBLIES

1-5

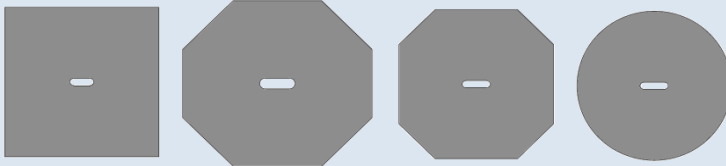
**DESCRIPTION:** THIMBLE, WIRE**MATERIAL:** MILD STEEL**SIZE:** 70mm x 20mm x Ø40mm**FINISH:** HOT DIP GALVANISED**DESCRIPTION:** STAY BASE PLATE**MATERIAL:** MILD STEEL**SIZE:** VARIABLE**FINISH:** HOT DIP GALVANISED**NOTES:**

Stay base plates are used in conjunction with stay rods. The size and thickness varies, depending on soil conditions, and load being supported by the stay rods. Various shapes are also produced with the most common being square, octagonal and round.

Stay rods are used in the staying of electrification, telecommunication and railway electrification poles. Non-adjustable stay rods are mostly used in conjunction with preformed wire products while adjustable stay rods allows for easy re-tensioning during the course of ongoing maintenance.

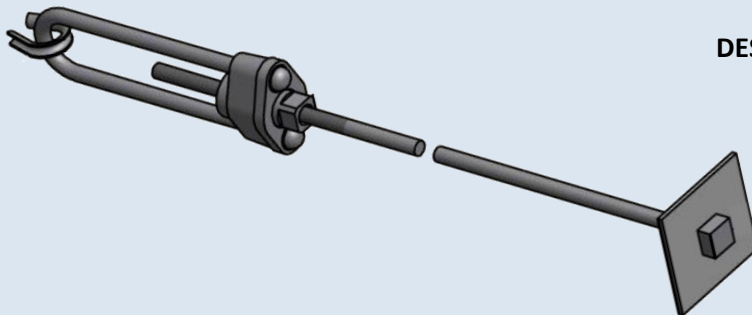
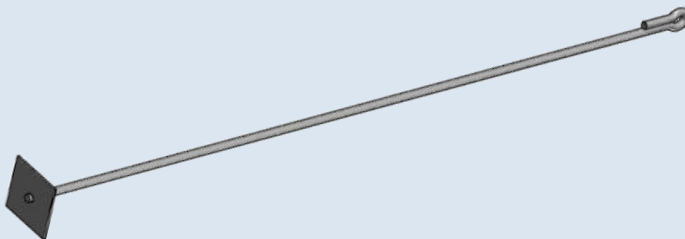
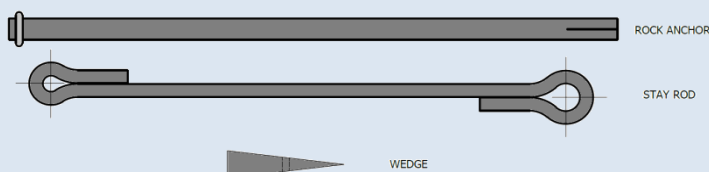
**DESCRIPTION:** ADJUSTABLE STAY ROD**MATERIAL:** MILD STEEL**SIZE:** M16, M20, M24**LENGTH:** VARIABLE**FINISH:** HOT DIP GALVANISED**DESCRIPTION:** NON ADJUSTABLE STAY ROD**MATERIAL:** MILD STEEL**SIZE:** M12, M16, M20, M24**LENGTH:** VARIABLE**FINISH:** HOT DIP GALVANISED**DESCRIPTION:** ROCK ANCHOR**MATERIAL:** MILD STEEL**SIZE:** 96kN & 114kN**FINISH:** HOT DIP GALVANISED

BRACKETS AND STRAPS

1-6

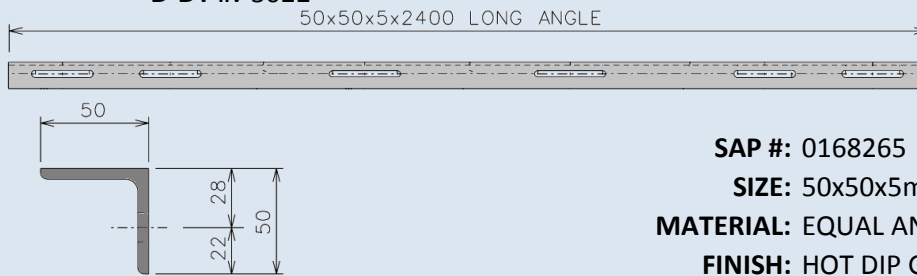
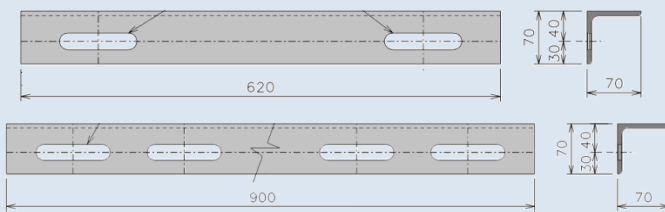
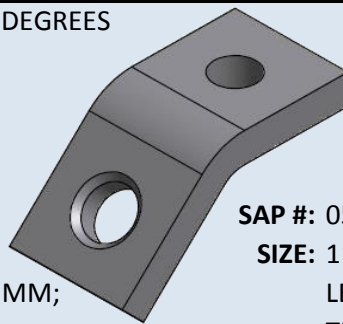
DESCRIPTION: BRACKET, TYPE F METER BOX**D-DT #:** 3022**SAP #:** 0168265**SIZE:** 50x50x5mm 2400mm LONG**MATERIAL:** EQUAL ANGLE IRON 250MPa STEEL**FINISH:** HOT DIP GALVANISED**DESCRIPTION:** TRANSFORMER PLATFORM ANGLE BRACKET**D-DT #:** 3023**SAP #:** 0175466**SIZE:** 70x70x6x6.38kg/mx620mm LONG**SAP #:** 0184235**SIZE:** 70x70x6x6.38kg/mx900mm LONG**MATERIAL:** EQUAL ANGLE IRON S355JR/350WA**FINISH:** HOT DIP GALVANISED**DESCRIPTION:** STAY BRACKET; 45 DEGREES**D-DT #:** 3032**SAP #:** 0163398**SIZE:** 96kN

LENGTH: 121 MM; WIDTH: 60 MM;

THICKNESS: 16MM

MATERIAL: STEEL GRADE: S355JR**FINISH:** HOT DIP GALVANISED**SAP #:** 0565723**SIZE:** 112kN

LENGTH: 131 MM; WIDTH: 70 MM;

THICKNESS: 16MM

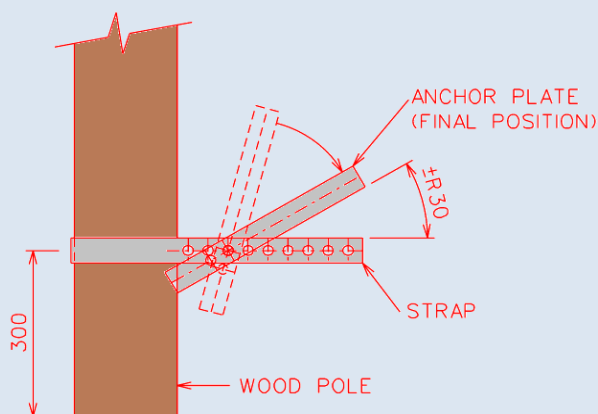
MATERIAL: STEEL GRADE: S355JR**FINISH:** HOT DIP GALVANISED**DESCRIPTION:** SOIL ANCHOR ASSEMBLY (KICK PLATE)**D-DT #:** 3035

ANCHOR PLATE ASSEMBLED

**SAP #:** 0164313**SIZE:** 380x220x70**MATERIAL:** GRADE S355JR/350WA STEEL**FINISH:** HOT DIP GALVANISED

BRACKETS AND STRAPS

1-7

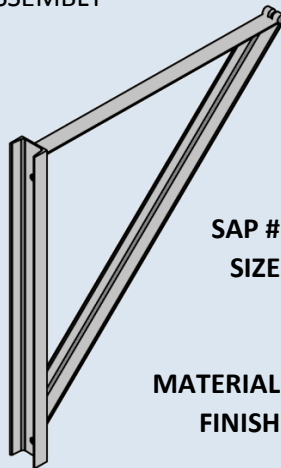
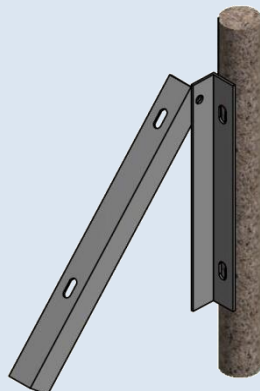
DESCRIPTION: POLE TOP (ALSO KNOWN AS L-TYPE) BRACKET**D-DT #:** 3046**SAP #:** 0168552**SIZE:** 402x60x110 ARM**MATERIAL:** GRADE 300W STEEL**FINISH:** HOT DIP GALVANISED**DESCRIPTION:** D-BRACKET FOR SHACKLE INSULATOR**D-DT #:** 3096**NOTE:** Suitable for S.1 and S.05 size LV shackle insulators**SAP #:** 0168895**SIZE:** 135x50x102 17.5mm**MATERIAL:** S355JR/350WA STEEL**FINISH:** HOT DIPPED GALVANISED**SAP #:** 0168776**SIZE:** 120x50x91 17.5mm**MATERIAL:** S355JR/350WA STEEL**FINISH:** HOT DIPPED GALVANISED**DESCRIPTION:** HIP STAY BRACKET ASSEMBLY**D-DT #:** 3106**SAP #:** 0219922**SIZE:** 1100 LONG CHANNEL, 950 LONG ANGLE, 1352 LONG ANGLE, Ø30 x 60 LONG SOLID ROUND STEEL BAR ROLLER**MATERIAL:** GRADE S355JR/350WA STEEL**FINISH:** HOT DIPPED GALVANISED**DESCRIPTION:** SWIVEL STRUT BRACKET (CONCRETE POLE)**D-DT #:** 3150**SAP #:** 0164291**SIZE:** 70 x 70 x 6 x 800mm LONG ANGLE IRON &

70 x 70 x 6 x 650mm LONG ANGLE IRON

MATERIAL: GRADE S355JR/350WA STEEL**FINISH:** HOT DIPPED GALVANISED

BRACKETS AND STRAPS

1-8

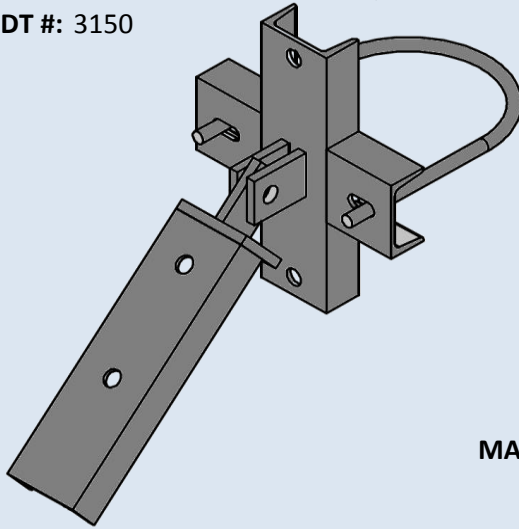
DESCRIPTION: SWIVEL STRUT BRACKET (WOOD POLE)**D-DT #:** 3150**SAP #:** 0164307

SIZE: 60 x 80 x 12mm THICK FLAT STEEL ,
 100 x 80 x 12mm THICK FLAT STEEL,
 100 x 50 x 11 x 350mm CHANNEL IRON,
 100 x 50 x 11 x 100mm CHANNEL IRON,
 100 x 50 x 11 x 350mm CHANNEL IRON, &
 60 x 80 x 12mm THICK FLAT STEEL

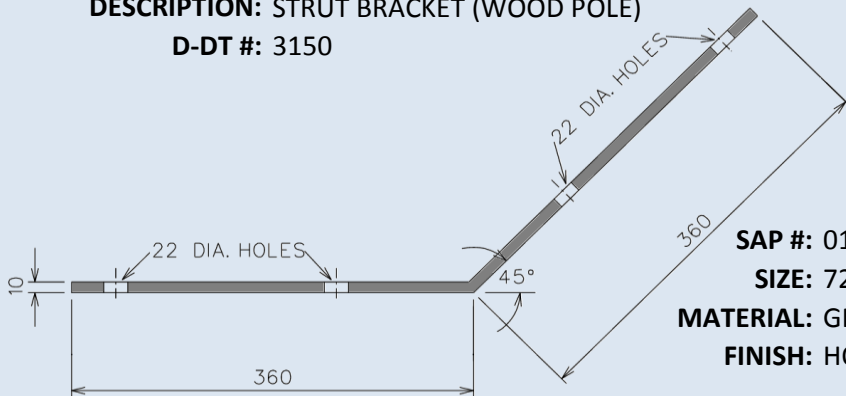
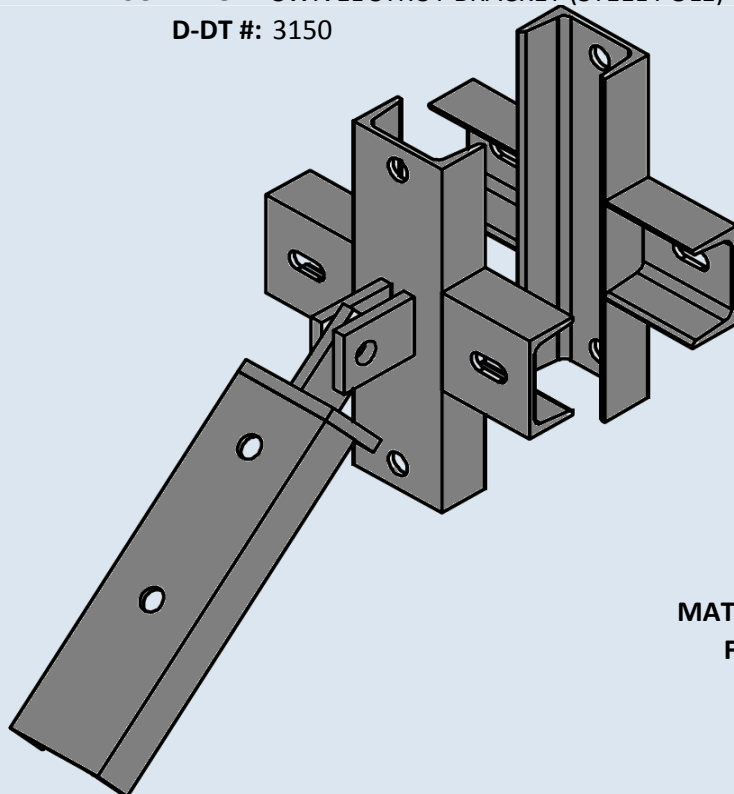
MATERIAL: GRADE 300W STEEL**FINISH:** HOT DIP GALVANISED**DESCRIPTION:** STRUT BRACKET (WOOD POLE)**D-DT #:** 3150**SAP #:** 0168525**SIZE:** 720mm x 60mm WIDE x 10mm FLAT STEEL**MATERIAL:** GRADE 300W STEEL**FINISH:** HOT DIP GALVANISED**DESCRIPTION:** SWIVEL STRUT BRACKET (STEEL POLE)**D-DT #:** 3150**SAP #:** 0225330

SIZE: 60 x 80 x 12mm THICK FLAT STEEL,
 100 x 80 x 12mm THICK FLAT STEEL,
 100 x 50 x 11 x 350mm CHANNEL IRON,
 100 x 50 x 11 x 100mm CHANNEL IRON,
 100 x 50 x 11 x 350mm CHANNEL IRON,
 60 x 80 x 12mm THICK FLAT STEEL

MATERIAL: GRADE S355JR/350WAS STEEL**FINISH:** HOT DIPPED GALVANISED

BRACKETS AND STRAPS

1-9

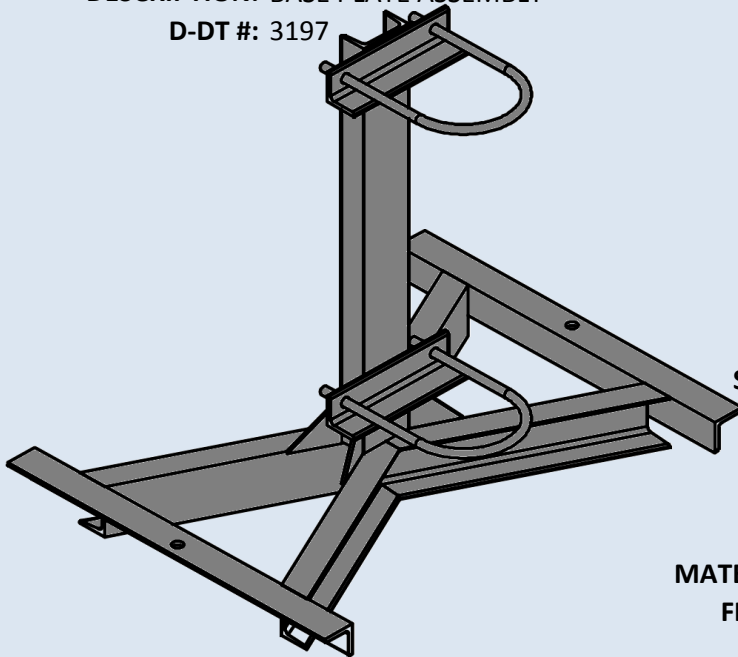
DESCRIPTION: BASE PLATE ASSEMBLY**D-DT #:** 3197**SAP #:** 0163427

SIZE: 100x50x10x890 LONG PF CHANNEL,
60x60x700 LONG ANGLE,
100x50x10x800 LONG PF CHANNEL,
100x100x6 THICK FLAT BAR,

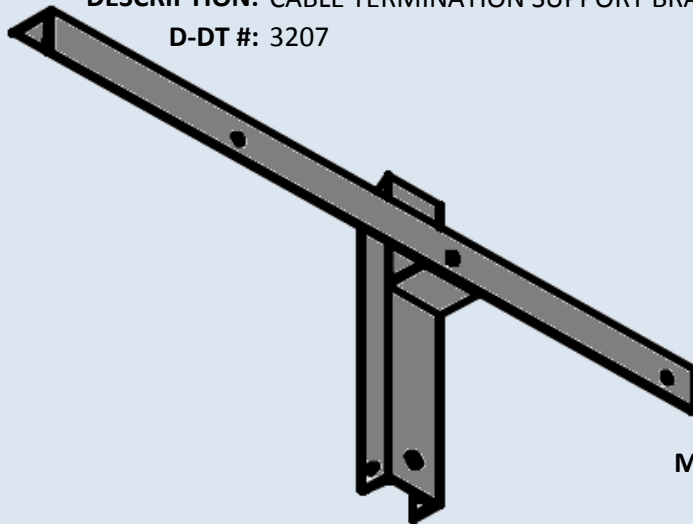
MATERIAL: GRADE 300W STEEL**FINISH:** HOT DIP GALVANISED**DESCRIPTION:** CABLE TERMINATION SUPPORT BRACKET**D-DT #:** 3207**SAP #:** 0175536

SIZE: 70x70x6x1200 LONG ANGLE,
70x70x6x100 LONG ANGLE , AND
100x50x11x500 LONG CHANNEL

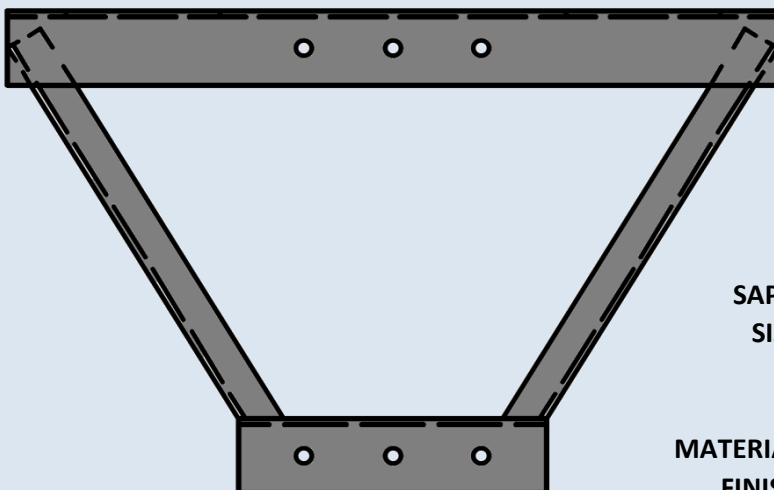
MATERIAL: GRADE 300W STEEL**FINISH:** HOT DIP GALVANISED**DESCRIPTION:** SINGLE POLE MOUNTED PLATFORM SUPPORT CRADLE**D-DT #:** 3220**SAP #:** 0184236

SIZE: 100 x 75 x 8 x 1000 UNEQUAL ANGLE
100 x 75 x 8 x 400 UNEQUAL ANGLE, AND
50 x 50 x 8 x 620 ANGLE

MATERIAL: GRADE 300W STEEL**FINISH:** HOT DIP GALVANISED

BRACKETS AND STRAPS

1-10

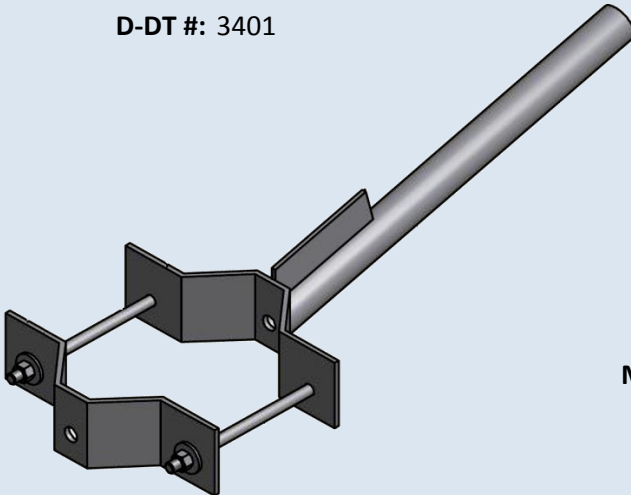
DESCRIPTION: DOUBLE MOUNTED SURGE ARRESTER BRACKET**D-DT #:** 3227**SAP #:** 0185978**SIZE:** 40 x 5 x 220mm LONG FLAT STEEL**MATERIAL:** 250MPa STEEL**FINISH:** HOT DIPPED GALVANISED**DESCRIPTION:** STREET LIGHT BRACKET FOR WOOD POLES**D-DT #:** 3401**SAP #:** 0164670**SIZE:** 80 x 6 x 340 LONG FLAT STEEL

40 x 5 x 140 LONG FLAT STEEL

42 O/D x 3.0 x 500 CIRCULAR HOLLOW

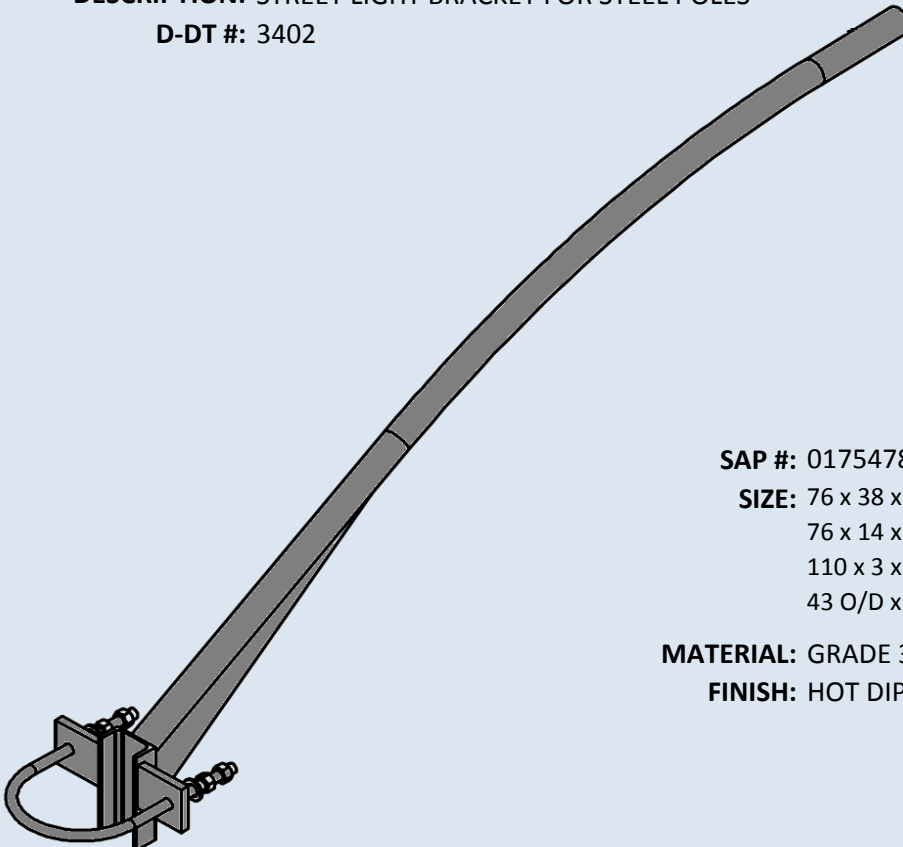
MATERIAL: GRADE 300W STEEL**FINISH:** HOT DIP GALVANISED**DESCRIPTION:** STREET LIGHT BRACKET FOR STEEL POLES**D-DT #:** 3402**SAP #:** 0175478**SIZE:** 76 x 38 x 7 x 165 CHANNEL,

76 x 14 x 87 FLAT STEEL,

110 x 3 x 684 FLAT STEEL

43 O/D x 3.0 x 1524 CIRCULAR HOLLOW SECTION

MATERIAL: GRADE 300W STEEL**FINISH:** HOT DIP GALVANISED

BRACKETS AND STRAPS

1-11

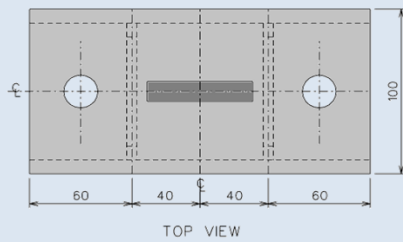
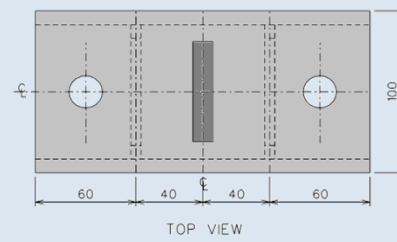
DESCRIPTION: STRAIN BRACKET FOR LARGE CONDUCTORS WITH UTS 120kN**D-DT #:** 7039**OPTION 1****OPTION 2****SAP #:** 0175538

0210592

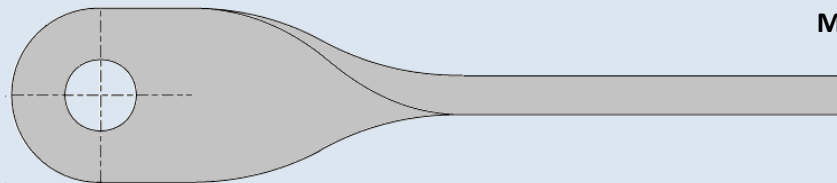
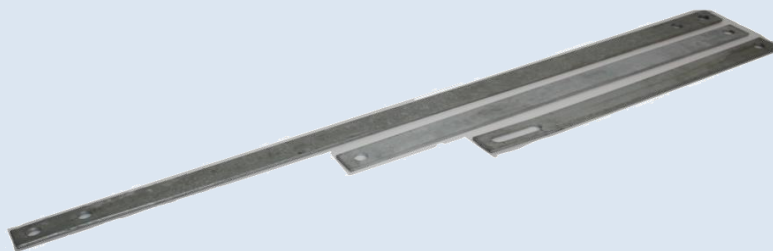
SIZE: 100x50x10 x 200mm PF CHANNEL, 60x10x80mm FLT BAR & 45x6x83 FLT BAR (GUSSETS)**MATERIAL:** GRADE 300W STEEL**FINISH:** HOT DIP GALVANISED**DESCRIPTION:** TWISTED CROSS-ARM LINK**MATERIAL:** MILD STEEL**GRADE:** 250MPa**SIZE:** 50 X 5MM THICK**LENGTH:** 220mm**FINISH:** HOT DIP GALVANISED**SAP#:** 0168540**DESCRIPTION:** TIE (DIAGONAL) STRAP**MATERIAL:** MILD STEEL**GRADE:** 250MPa**FINISH:** HOT DIP GALVANISED**SAP#:** **DIMENSIONS:**

0168553 910x50x6

0168775 701x50x6

0179728 1410x50x6

PROFILING

1-12

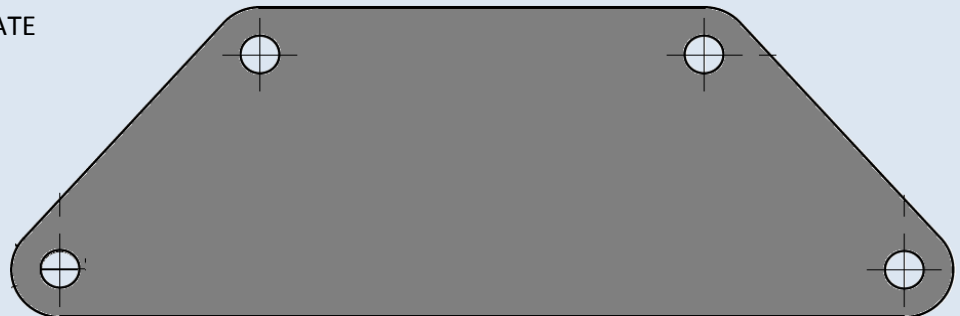
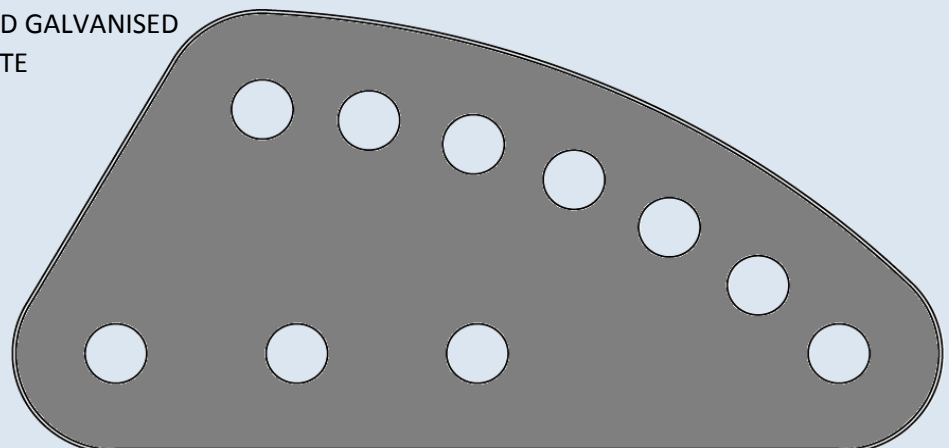
DESCRIPTION: TRIANGULAR YOKE PLATE 120kN**D-DT #:** 7015**MATERIAL:** GRADE S355JR/350WA STEEL**FINISH:** HOT DIPPED GALVANISED**SIZE:** 16mm PLATE**SAP #:** 0010842**SAP #:** 0168861**SAP #:** 0168961**DESCRIPTION:** TRAPEZOIDAL YOKE PLATE 120kN**D-DT #:** 7016**MATERIAL:** GRADE S355JR/350WA STEEL**FINISH:** HOT DIPPED GALVANISED**SIZE:** 16mm PLATE**SAP #:** 0168862**DESCRIPTION:** SAG ADJUSTOR 120kN**D-DT #:** 7042**MATERIAL:** GRADE S355JR/350WA STEEL**FINISH:** HOT DIPPED GALVANISED**SIZE:** 16mm PLATE**SAP #:** 0175857

STUBBIES

1-13

WHAT IS THE NUMILL POLE STUB SYSTEM?

The Numill Pole Stub System is a patented, tested and approved stubbing solution. It is a preventative and corrective system used as an alternative for full pole replacement. The Numill system is a complete pole maintenance package and includes:-

Onsite proof load Testing / Reporting, & Pole stubbing.

WHAT ARE THE PRO'S, CONS & CORRECTIVE MEASURES TAKEN FOR THE NUMILL POLE STUB SYSTEM?

PRO'S:

- * Stubbing is +- 55% more cost effective than pole replacement.
- * Time of installations: +-300% faster.
- * Product is installed under live line conditions.
- * Pole life is extended.
- * Stub system retains value at end of life / Stubs are re-usable.
- * Very quick installation (+- 2 hours per pole)

CONS:

- * Threat of theft.
- * Inaccurate installation may cause failure.
- * Installation may be problematic in built up-environments.
- * Rejected poles (Class 5) generally not suitable to stub.

CORRECTIVE MEASURES:

- * Thread portion above nut is welded.
 - a) Lock Nuts
 - b) Crimp threads / weld
- * Trained installers have correct installation procedures in site file. No alternatives allowed.
- * If the pole is next to built up wall. If it is not possible to stub, Pole replacement will be done.
- * Pole deterioration, For example by termites: Pole replacement will take place.

APPLICATIONS:

- * LV distribution poles.
- * MV distribution poles.
- * 66kV wood pole transmission lines.
- * 132kV wood pole transmission lines.

CONSTRUCTION:

- * Various designs to accommodate required applications.
- * Steel construction made from 2 x L-shaped stub brackets.
- * Grouted ground anchors to secure brackets in soil.
- * Threaded-rod ties are used to secure pole between stub brackets.
- * All loose components welded together.

HOW DOES IT FUNCTION?

- * A degraded wooden pole is identified by means of NDT testing.
- * Depending on the classification and pole size a suitable stub size is selected.
- * The stub is placed 90 degrees to the line direction and anchored by means of grouted ground anchors. Once the anchors have been tested to a Proof load (80kN) the stub brackets are mounted and then

STUBBIES

1-14

DESCRIPTION: LV/MV STUBB

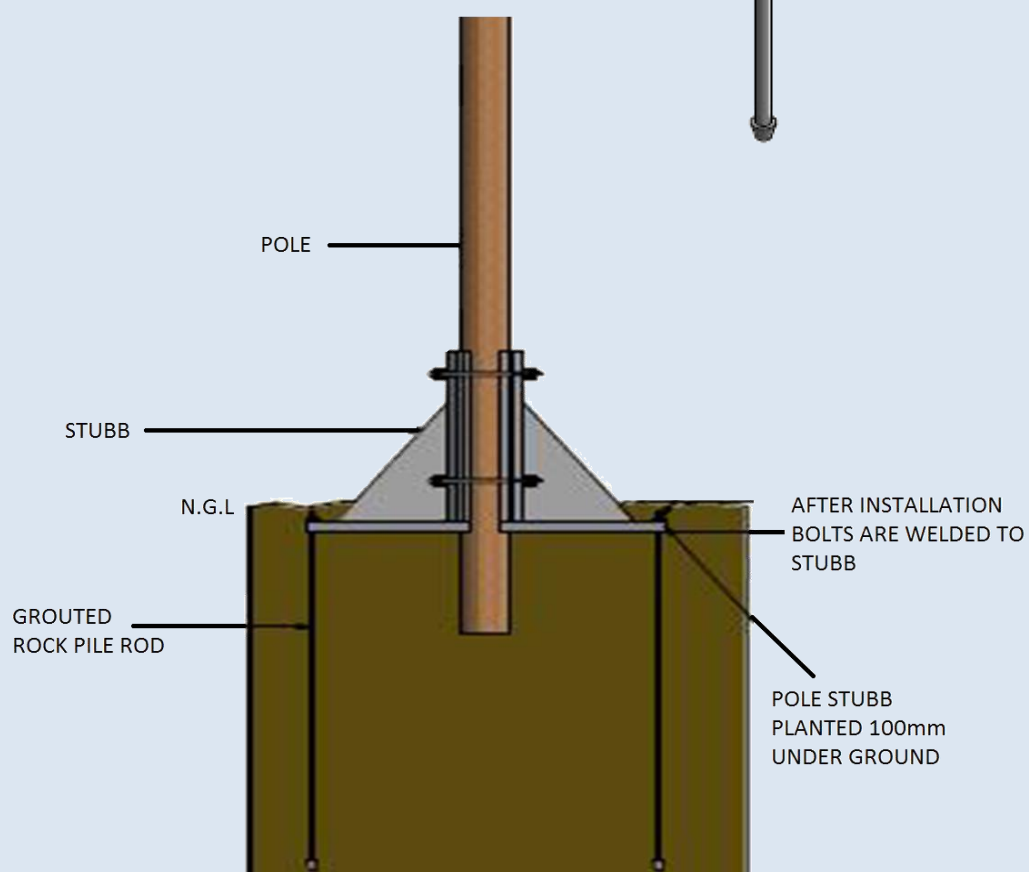
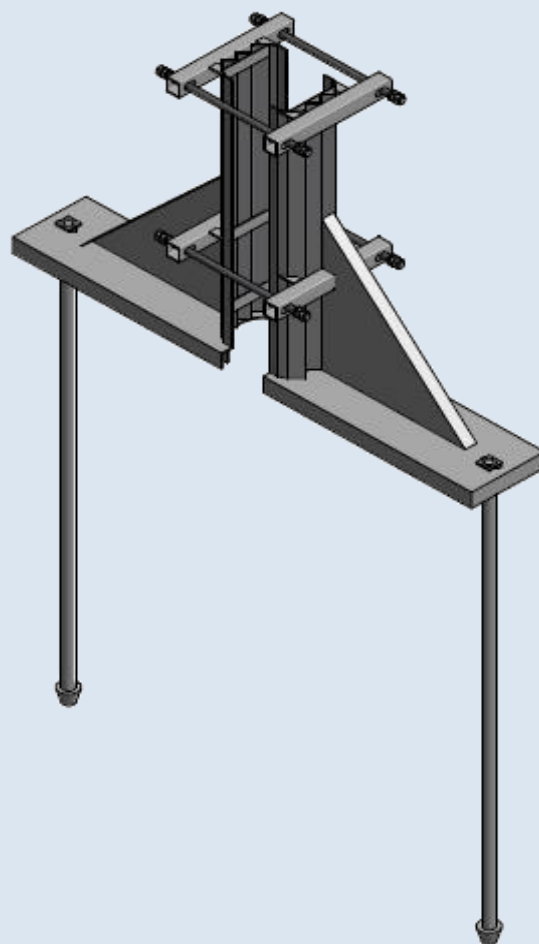
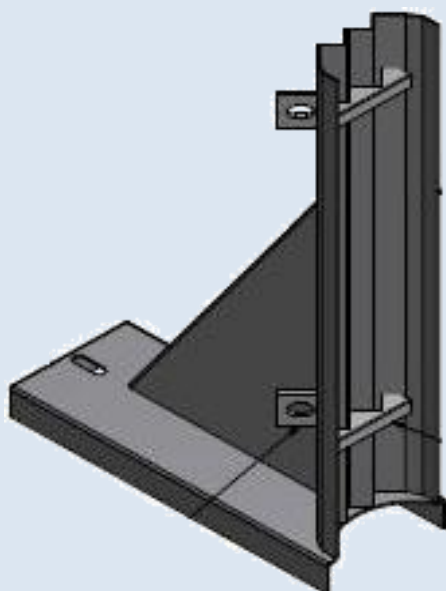

STUBBIES

1-15

DESCRIPTION: STUBB FOR ROCKY AREAS

